

TOWNSHIPS 4 TO 6 SOUTH, RANGES 42 TO 46 EAST, OF THE WILLAMETTE MERIDIAN, OREGON

AMENDED PROTRACTION DIAGRAM FILE 22, UNIT 2

SHEET 1 OF 11

UNSURVEYED

R. 42 E. R. 43 E. R. 44 E. R. 45 E. R. 46 E.

T. 4 S.

T. 5 S.

T. 6 S.

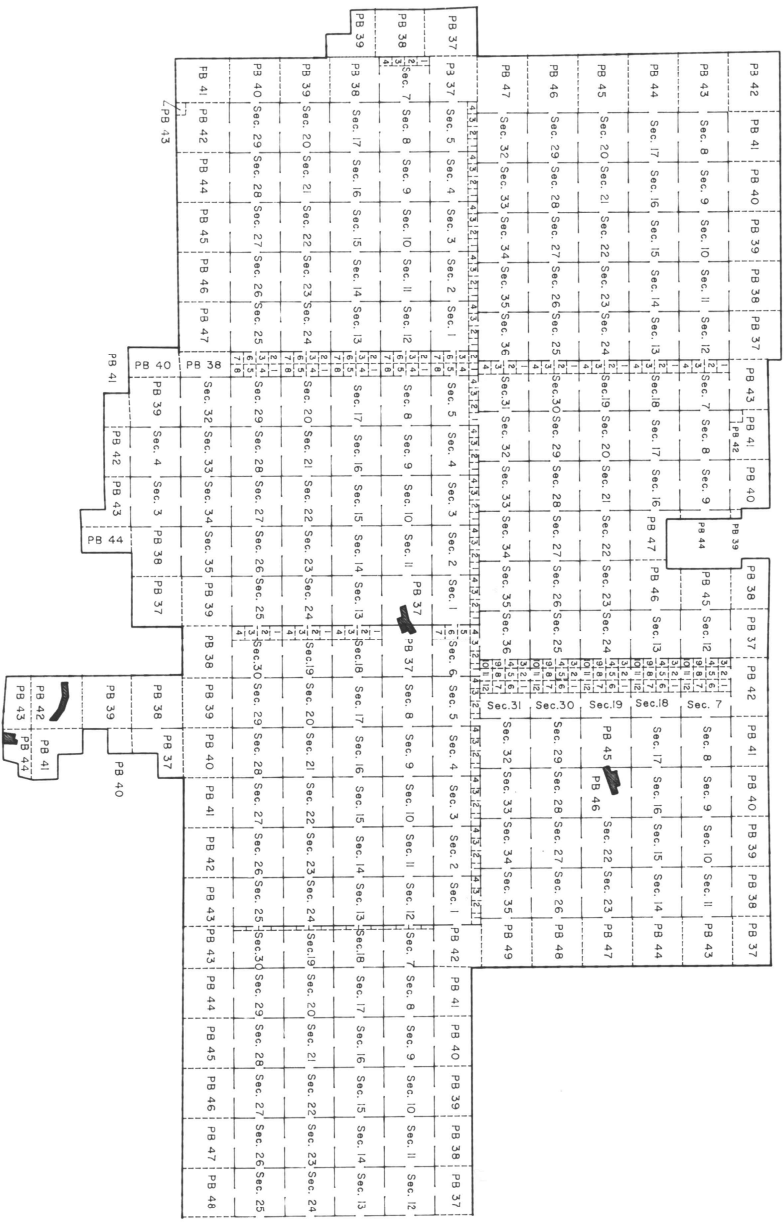

TOWNSHIP INDEX

T. 5 S.	R. 42 E.	Sheet 2
T. 4 S.	R. 43 E.	Sheet 3
T. 5 S.	R. 43 E.	Sheet 4
T. 4 S.	R. 44 E.	Sheet 5
T. 5 S.	R. 44 E.	Sheet 6
T. 6 S.	R. 44 E.	Sheet 7
T. 4 S.	R. 45 E.	Sheet 8
T. 5 S.	R. 45 E.	Sheet 9
T. 6 S.	R. 45 E.	Sheet 10
T. 5 S.	R. 45 E.	Sheet 11

UNITED STATES DEPARTMENT OF THE INTERIOR
BUREAU OF LAND MANAGEMENT
Portland, Oregon
December 24, 1996
This diagram represents the official protraction of the rectangular system of surveys and is hereby accepted.

For the Director
Wayne M. Schaefer
Chief Cadastral Surveyor of Oregon